

# 500 Series

## UHP Stainless Steel Bellows Valve Manual & Pneumatic

aerospace  
climate control  
electromechanical  
filtration  
fluid & gas handling  
hydraulics  
pneumatics  
process control  
sealing & shielding

### Value Proposition:

Parker Hannifin Corporation's Veriflo Division presents the 500 Series Manual & Pneumatic Operated Bellows Valves.

These valves are designed with the industry's leading straight-through full flow. This allows for maximum gas transfer through the main and lateral lines inside the fabrication facility.



### Contact Information:

Parker Hannifin Corporation  
**Veriflo Division**  
250 Canal Blvd  
Richmond, California 94804

phone 510 235 9590  
fax 510 232 7396  
veriflo.sales@parker.com

www.parker.com/veriflo  
Mobile App: m.parker.com/veriflo

### Product Features:

- Standard surface finish of 10 micro inch Ra
- Standard full internal electroplish
- Fully functional from vacuum to 250 psig
- AOP version available in 1/2" size
- Serialized and heat code traceable
- Vericlean™, Veriflo's low sulfur high purity 316L Stainless Steel enhances electropolishing, welding, and corrosion resistance
- 100% Helium leak tested
- Optimum purge port location



ENGINEERING YOUR SUCCESS.

# 500 Series

## Dimensional Drawings

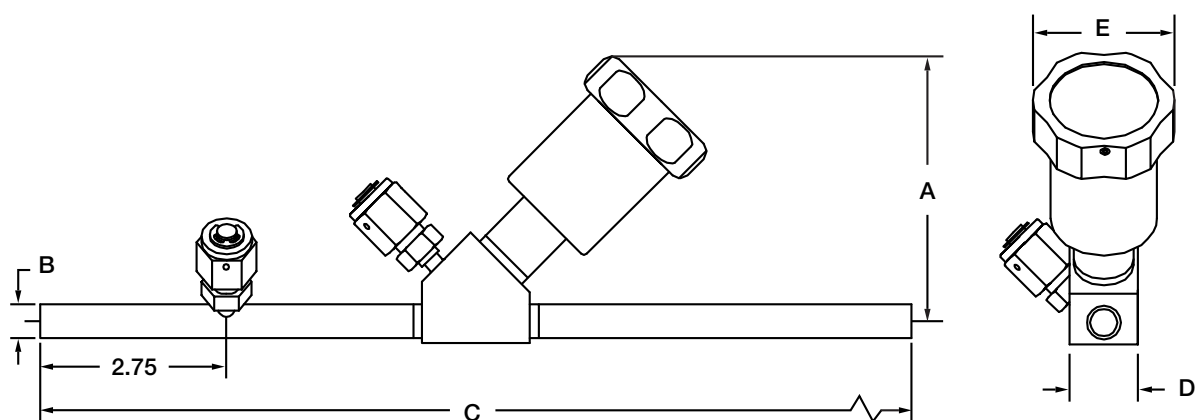

(Manual) Part Number	A (open/close)	B (size X wall)	C	D	E	Straight or Tube Exp.
UHP504**-*	4.3/3.9	0.50 X 0.049	12.8	1.00	2.1	Straight
UHP506**-*	7.2/6.5	0.75 X 0.065	13.5	1.65	3.0	Straight
UHP506**08-*	7.2/6.5	1.00 X 0.065	16.5	1.65	3.0	Tube Exp.

Note: Metric tube sizes and wall thickness available upon request.  
Dimensions in inches.

(AOP) Part Number	A	B (size X wall)	C	D	E
UHP504*A-*	10.0	0.50 X 0.049	12.8	1.00	5.0
UHP504*B-*	7.3	0.50 X 0.049	12.8	1.00	4.0
UHP504*F-*	9.0	0.50 X 0.049	12.8	1.00	5.0

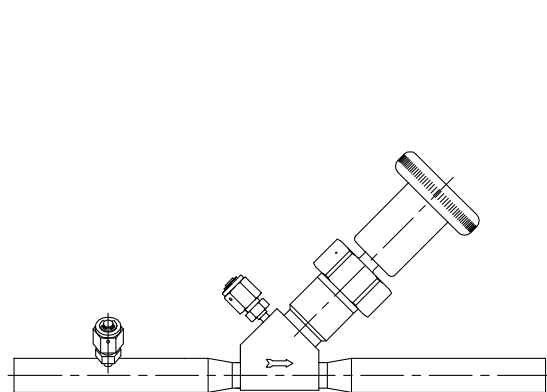

**TUBE STUB EXPANDER**

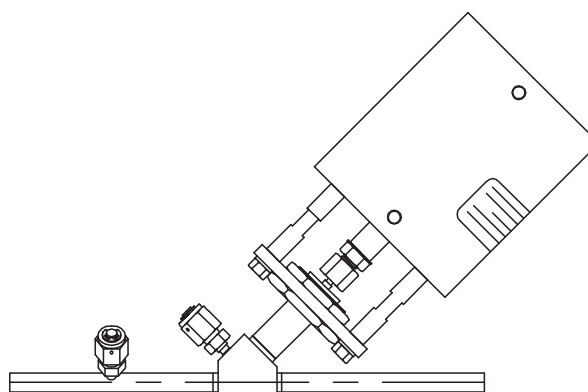

**PNEUMATIC ACTUATION**

Safety Guide and Installation and Operating Instructions available at  
[www.parker.com/veriflo](http://www.parker.com/veriflo)

# 500 Series

## Ordering Information

Build a 500 Series valve by replacing the numbered symbols with an option from the corresponding tables below.

Contact factory for most up to date lead time information.

Blue = Configurations that have selections in blue will require a price quote from the factory.

Sample:  **UHP**  **5**  **04**  **C**  **1**   **-10**

Finished Order: **UHP504C1-10**

 **Configuration**  
UHP = Straight Valve

 **Basic Series**  
5 = 500 Series

 **Body Size**  
04 = 1/2"  
06 = 3/4"

 **Purge Port**  
A = None  
C = Up and Downstream  
D = Downstream

 **Actuation**  
Manual (handle color)  
1 = Blue  
Pneumatic "04" Body Only.  
A = Fail Close Actuation  
B = Double Acting Actuation  
F = Fail Open Actuation  
*Consult Factory for additional Handle Colors*

 **Inlet/Outlet Fitting Size & Type**  
"04" Body Style  
= 1/2" Tube Stub *Standard*  
M4M4 = 1/2" Male Face Seal Fitting  
F4F4 = 1/2" Female Face Seal Fitting  
"06" Body Style  
= 3/4" Tube Stub *Standard*  
08 = 1" Expanded Tube Stub

 **Internal Surface Finish**  
10 = 10 Ra

Additional configurations available upon request

# 500 Series

## Specifications

Materials of Construction		Functional Performance	
<b>Wetted</b>		<b>Flow Capacity</b>	
Body	VeriClean™ 316L Stainless Steel	UHP504	C <sub>V</sub> 4.8
Tube Ends	316L Stainless Steel	UHP506	C <sub>V</sub> 17.4
Stem	316L Stainless Steel	<b>Leak Rate</b>	
Seat Holder	316L Stainless Steel	Inboard Test Method	
Bellows Adapter	316L Stainless Steel	Internal	≤ 1 X 10 <sup>-9</sup> scc/sec He
Bellows	321 Stainless Steel	External	≤ 1 X 10 <sup>-10</sup> scc/sec He
Seat	PCTFE	<b>Surface Finish</b>	
Bonnet Gasket	Nickel	10 micro inch Ra	
<b>Non-wetted</b>		<b>Operating Conditions</b>	
<b>Pneumatic</b>		Maximum Pressure	250 psig (17 barg)
Actuator Housing	Aluminum	Minimum Pressure	Vacuum
Actuator Adapter	303 Stainless Steel	Maximum Temperature	140°F (60°C)
Actuator Plate	Aluminum		
Bonnet	Brass		
Bonnet Adapter	303 Stainless Steel		
Bearing	Bronze		
Set Screw	316 Stainless Steel		
<b>Manual</b>			
Hand Wheel	Aluminum		
Bonnet	Brass		
Bearing	Bronze		

VeriClean™ is a trademark of Parker Hannifin Corporation

For additional information on materials of construction, functional performance and operating conditions, please contact factory.

### OFFER OF SALE:

The items described in this document are hereby offered for sale by Parker-Hannifin Corporation, its subsidiaries or its authorized distributors. This offer and its acceptance are governed by the provisions stated in the detailed "Offer of Sale" elsewhere in this document or available at [www.parker.com/veriflo](http://www.parker.com/veriflo)



FAILURE OR IMPROPER SELECTION OR IMPROPER USE OF THE PRODUCTS DESCRIBED HEREIN OR RELATED ITEMS CAN CAUSE DEATH, PERSONAL INJURY AND PROPERTY DAMAGE. THIS DOCUMENT IS FOR REFERENCE ONLY. PLEASE CONSULT FACTORY FOR LATEST PRODUCT DRAWINGS AND SPECIFICATIONS

This document and other information from Parker-Hannifin Corporation, its subsidiaries and authorized distributors provide product or system options for further investigation by users having technical expertise.

The user, through its own analysis and testing, is solely responsible for making the final selection of the system and components and assuring that all performance, endurance, maintenance, safety and warning requirements of the application are met. The user must analyze all aspects of the application, follow applicable industry standards, and follow the information concerning the product in the current product catalog and in any other materials provided from Parker or its subsidiaries or authorized distributors.

To the extent that Parker or its subsidiaries or authorized distributors provide component or system options based upon data or specifications provided by the user, the user is responsible for determining that such data and specifications are suitable and sufficient for all applications and reasonably foreseeable uses of the components or systems.

The products described herein, including without limitation, product features, specifications, designs, availability and pricing are subject to change by Parker Hannifin Corp and its subsidiaries at any time without notice.

Proposition 65 Warning: This product contains chemicals known to the state of California to cause cancer or birth defects or other reproductive harm.

© 2009 Parker Hannifin Corporation



Use mobile device to scan this QR Code.

LitPN: 25000269

Rev: E

Date of Issue 03/2017



ENGINEERING YOUR SUCCESS.